

MAP Sensor

A - Ground
B - Signal
C - Power

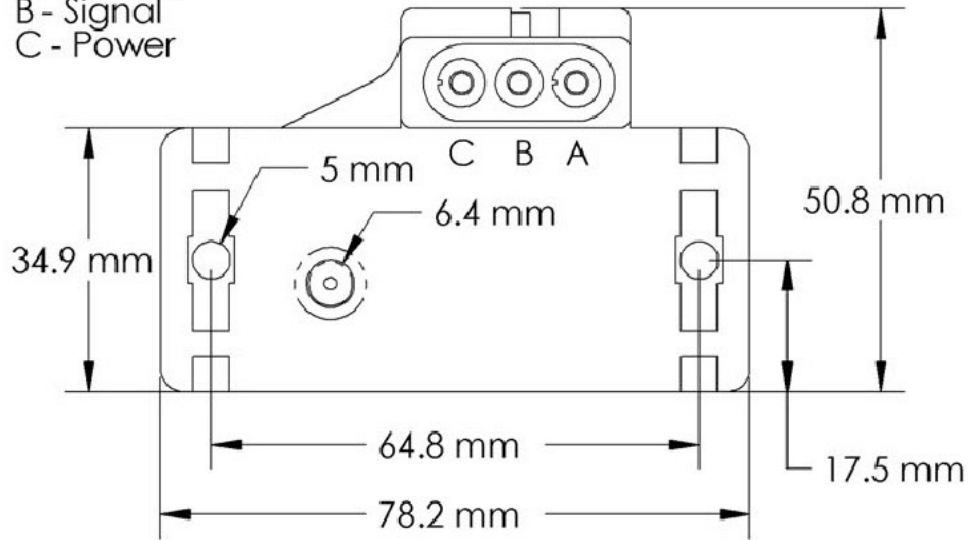

Operating Voltage: 5 Volts (supplied by ECU)
 Supply Current: < 6.0 mA
 Pressure Range: 3 to 14.8 psi (20 to 102 kPa)
 Output Signal: .25 to 4.85 Volts
 Operating Temperature: -40° C to + 125° C
 Moisture Resistance: 600 hrs, 90%RH, -5° C to +35° C
 Fluid/Vapor Resistance: All engine fluids

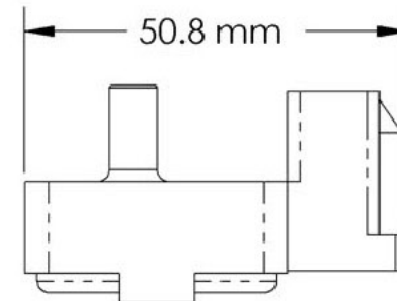
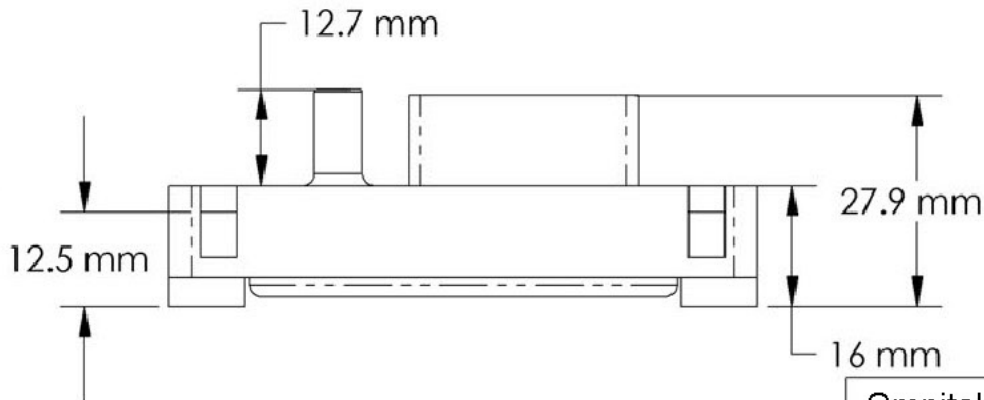
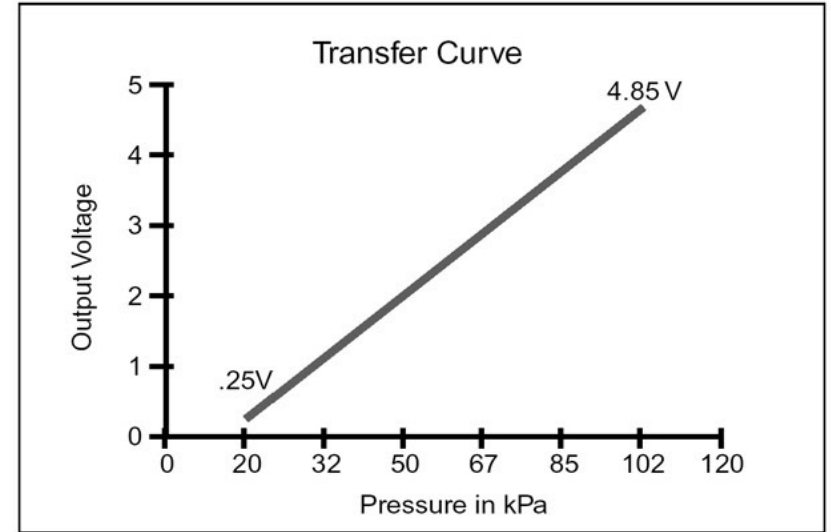

Omnitek Engineering, Corp.		Part #	13201	Drawing #	
Sheet 1 of 1		Description: MAP Sensor		Scale 1 : 1	Revision 0
Material: TBA	Finish: TBA	Drawn By: TE	Approved By:	Date: January 5, 2000	